



யா/ ஹாட்லிக் கல்லூரி, பருத்தித்துறை.
J/ Hartley College, Point Pedro.



முதலாம் தவணைப் பரீட்சை – 2020 – தரம் 11
First Term Examination – 2020 – Grade 11

ஆங்கில மொழி I
English Language I

31

E

I

ஒரு மணித்தியாலம்
One Hour

கட்டெண்
Index No

--	--	--	--	--

English Language I

ANSWER ALL QUESTIONS ON THIS PAPER ITSELF.

Q 01	
Q 02	
Q 03	
Q 04	
Q 05	
Q 06	
Q 07	
Q 08	
P I	
P II	
Total	

Test - 01

Match the following persons with their descriptions. Write the correct letter in the blank. *One is done for you.*

a. Mahout b. Sprinter c. Inhabitant d. Monk e. Hacker f. Peer

1. A person or animal that lives in a place. -**c**.....
2. An athlete who races over short distances. -
3. A person who works with rides and tends to an elephant. -
4. A person who uses computers to gain unauthorised access to data. -
5. A member of religious group of men who lives in a monastery. -
6. A person who is the same age as other people in a group. -

Test - 02

Read the following paragraph and write the necessary information in the space given below.

The annual get - together of English Teachers' union of the western province will be held on Sunday the 27th of March commencing at 9.30 a.m. at Suranga Conference Hall. This year, the usual venue of Lumbini hall has been changed due to on-going repairs to the Lumbini hall. The Minister of Education, Mr.Dalas Alagaperuma will be the Chief Guest. As usual, the day's programmes will commence with the lighting of the oil lamp by the Chief Guest.

- a. Name of the event -
- b. Usual venue -
- c. Reason for changing usual venue -
- d. Designation of the chief guest -
- e. Usual event takes before day's programmes-

Q 01

1 ×

Total 5

Q 02

1 ×

Total 5

Test - 03

Study the picture. Fill in the blanks with the words given in the box. Write the correct letter in the space.

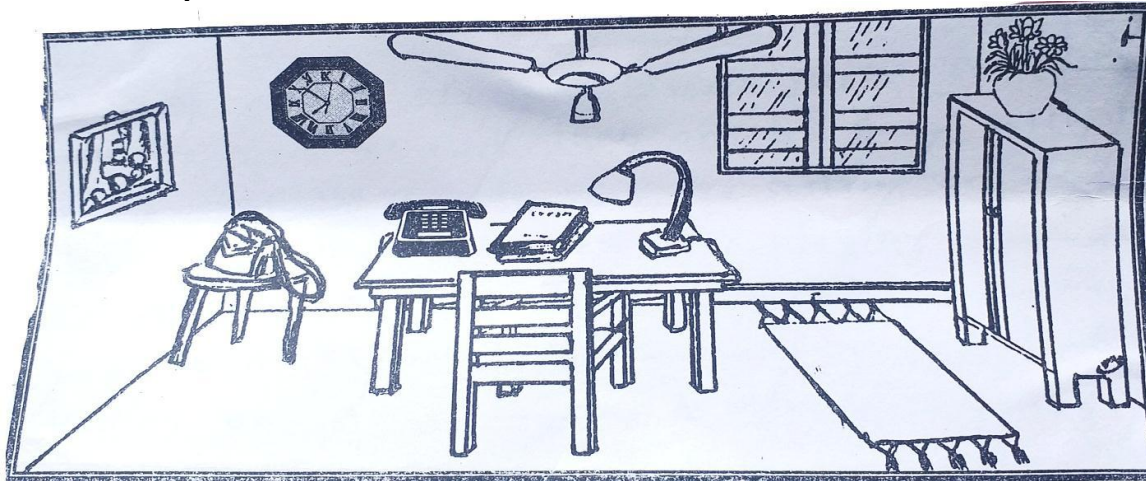

This is a picture of Mrs. Sarojini's room. There is a table and a in the room. A of books, a telephone and a can be seen on the table. In the room, she has kept her on a stool which is in a corner of the room. There is a ceiling fan with three A can also be seen on the floor. There is a wall clock fixed to the The of the window are closed. A is kept on the book shelf. Mrs. Sarojini keeps her room neat and

blades / Chair / pile / flower vase / table lamp/ hand bag / door mat / wall/ tidy / doors

Q 03

$\frac{1}{2} \times$
Total 5

Test - 04

The letter given below has some errors. They are underlined. Correct them as shown in the example.

The Manager,
Lanka Cement Factory.

No 24, Temple Road,
Jaffna.

Dear Sir,

20.03.2020

Thank you for you kind gesture, allowing us to visit your shoe factory. We would like to thank you for create a positive environment for our students. We would like to express our thanks for your warm recept and gracious hospitable. Please convey our appreciation to your workers for a nice detail interpretation. Without your advice, we would not have enjoy ourselves very much.

- | | | |
|----------------------------|---------|---------|
| 1. <u>You - your</u> | 3. | 5. |
| 2. | 4. | 6. |

Q 04

$1 \times$
Total 5



யா/ ஹாட்லிக் கல்லூரி, பருத்தித்துறை.
J/ Hartley College, Point Pedro.

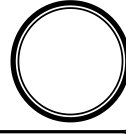

முதலாம் தவணைப் பரீட்சை – 2020 – தரம் 11
First Term Examination – 2020 – Grade 11

ஆங்கில மொழி II
English Language II

31

E

II

இரண்டு மணித்தியாலம்
Two Hours

சுட்டெண்
Index No

--	--	--	--	--

English Language II

Q 9	
Q 10	
Q 11	
Q 12	
Q 13	
Q 14	
Q 15	
Q 16	
P II	
Total	

ANSWER ALL QUESTIONS ON THIS PAPER ITSELF.

Test – 09

Complete the sentences selecting a word.

Flexible, flexibly, flexibility

1. You can improve your by exercising
2. They will use the funds to meet the demands of local villagers.
3. My schedule is I could arrange to meet with you any day next week.

appreciate, appreciative, appreciatively, appreciation

1. I don't being treated like a second class citizen.
2. She shows little of good music.
3. The company was very of my efforts.
4. He suddenly look down at her and winked

imprisoned, imprisonment, prisoners

1. He was three times for this antisocial activities.
2. He was sentenced to two months
3. They are demanding the release of all political

Test – 10

Complete the following story using the most appropriate form of the verb given within brackets.

A rich merchant had many servants in his house. One day, his wife's much loved necklace (disappear) from her cupboard. Gradually, precious things in the house started (disappear) one by one. The merchant troubled by the thief in his house (suspect) one of his servants to be thief. But it was very difficult to identify the thief among all other servants in his huge house. So, he (contact) a wise man and told about the recent incidents.

After (listen) to the merchant, the wise man summoned all the merchant's servants and started interrogating them one by one. He received but absolute denial from every servant.

An idea (strike) the wise man and he handed over a stick to every servant, all of them the same length. He told them that stick was magical and the stick of the thief (grow) by two inches the next day. The servants (order) to present the stick to the wise man the next day.

Q 09

$\frac{1}{2} \times$

Total 5

The next day as ordered, the servants (assemble) at merchant's house with their sticks. As the wise man examined each stick, he noticed that one of the servants..... (hold) a stick that was two inches shorter. “ This is the thief”, said the wise man. Giving reasons for his judgement the wise man said” Honest men never feared about the growth of their stick. The thief had already cut his stick by two inches shorter fearing that his stick will be longer by two inches next morning.

Q 10

$\frac{1}{2} \times$

Total 5

Test – 11

Read the following poem and do the activities that follow.

Soldier Daddy

To you I may be very small	I watch my mom and see her cry
Or think I don't know much at all	I already know but still ask why?
I've learned to grow up rather fast	Her heart is hurting yet she tries to smile
with so much future and no much past.	And we hold each other for a little while.

I'm just two years old but often sad	I'm still young yet very wise
I want so much to hug my dad	I have my fan but realize
He's protecting us from far away	My soldier daddy is brave and strong
His life on the line everyday	I pray his deployment won't be long.

(Gina M. Makonsky)

- According to the poem, Dad has gone.....

a) on a trip	c) to a battle field
b) abroad	d) to attend a meeting
- Who does the pronoun 'us' in the second stanza refer to?
.....
- How many stanzas are there in the poem?
.....
- Write one word from the poem which means the same as the following.

i) having good judgements	-
ii) movement of troops to a place for military action	-
- "I'm just two years old but often sad
I want so much to hug my dad"
These lines clearly refer to

i) How much the child hates his father
ii) The child wants his father to be at home with him
iii) The child longs for the company of his father to express love
iv) The child wants to hurt his father

Q 11

1 ×

Total 5

Test – 12

You met one of your friends at the inter school sports meet. Use reported speech and tell what that friend said. *One is done for you.*

1. “I enjoyed this meet.”

He said that **he had enjoyed that meet.**

2. “I have won 100m and 200m races.”

He said that

3. “I am going to practise more.”

He said that

4. “I can do my best next year.”

He said that

5. “The ground was decorated beautifully.”

He said that

6. “The chief guest appreciated my effort.”

he said that the chief guest

Q 12

1 ×

Total $\frac{1}{5}$

Test – 13

Fill in each blank with a suitable word from those given in the list below.

not since have future the in will leave
has being full of their than

It is the responsibility of today's youth to help create a better world for (1) generations. The fate of the world is (2) decided now. Awareness about (3) serious environmental threats to the world's well-being (4) grown considerably even in these few years (5) you were born. But obviously awareness is (6) quite enough. If you are to grow old (7) a healthy world, and if you hope to (8) a thriving planet to your children, and to (9) children, you will have to do better (10) the generations that (11) preceded you. The tools (12) modern technology (13) be yours as well as the libraries (14) of research experience gained from the past

Q 13

$\frac{1}{2} \times$

Total $\frac{1}{7}$

Test – 15

Read the following passage and answer the questions.

Rabies is an ordinarily infectious disease of the central nervous system, caused by a virus and, as a rule, spread chiefly by domestic dogs. Man and all warm – blooded animals are susceptible to rabies. The people of ancient Egypt, Greece and Rome thought rabies to be the work of evil spirits because ordinarily gentle and friendly animals suddenly became violent without evident cause and, after a period of wild behaviour, became paralyzed and died.

Experiments carried out in Europe in the early nineteenth century proved that the disease was infectious. Preventive steps, such as the destruction of stray dogs, were taken and by 1826 the disease was permanently eliminated in Norway, Sweden and Denmark, although urban centres on the continent of Europe were cleared several times during the nineteenth century, **they** soon became reinfected since rabies was uncontrolled among wild animals.

During the early stages of the disease, a rabid animal is most dangerous because it appears normal and friendly, but **it** will bite at the slightest provocation. The virus is present in the salivary glands and passes into the saliva so that the bite of the infected animal introduces the virus into a fresh wound. If no action is taken, the virus may become established in the central nervous system and finally attack the brain. The incubation period varies from ten days to eight months or more and the disease developed more quickly the nearer to the brain the wound is. Most infected dogs become restless, nervous and irritable and vicious, then depressed and paralyzed. With this type of rabies, the dog’s death is inevitable and usually occurs within three to five days after the onset of the symptoms.

1. What is the disease mentioned in the passage?
.....
2. Which sentence says that “Man and all warm – blooded animals likely or liable to be influenced by this disease”?
.....
3. Say whether following statements are true or false by writing **T or F** against them
 - a. Unless proper action is taken, it may attack the brain (.....)
 - b. Destruction of stray dogs was one of the measures taken by Norwegians to eliminate this disease. (.....)

4. Find the words from the text which mean the following.
- (i) Certain to happen; unavoidable (last paragraph)
- (ii) A physical or mental feature which is regarded as indicating a condition of a disease (last paragraph)
5. What do the following words in the text refer to?
- (i) 'They' in paragraph 2
- (ii) 'It' in paragraph 3
6. Where is the virus that causes rabies present?
.....
7. Underline the word that best explains the behaviour of the infected dog.
- (i) gentle
- (ii) friendly
- (iii) vicious
8. Study the three sub headings given below. Underline the most suitable sub heading to the last paragraph.
- a. Experiments and preventive measures.
- b. Behaviour of the dog after it has been infected.
- c. Origin of the disease.

Q 15

1 ×

Total $\frac{1}{8}$

Test – 16

Write on one of the following. Use about 200 words.

1. “Modern means of communication have improved the quality of human life.”
- What the modern means of communication are
 - How they make human life better
 - Any disadvantages
2. A speech to be made at your school morning assembly on ‘challenges make us strong’
- What challenges mean
 - Some challenges in day to day life
 - How to overcome them.
3. Write an “article to be sent to a newspaper on the following topic”
- “Tourist attractions in Sri Lanka”
4. You are the president of the English Literary Association. You are going to hold an “Inter - Class Drama Competition” at the term End. Write the dialogue that takes place between you and the members about it. Including the following.
- Who should be invited / awards, prizes /
 - Types of dramas
 - Cast, costumes, music, lighting... etc.

Q 16

C –

L –

O –

M –

$\frac{15}{15}$



Follow and Get papers Daily ..!



எங்கள் குறிக்கோள்

எண்ணிம உலகத்தில் மாணவர்களிற்கென சிறந்ததொரு கற்றல் கட்டமைப்பை உருவாக்குதல்.

அனைத்தும் டிஜிட்டல் மயப்படுத்தப்பட்ட இந்த காலத்தில் பல்வேறு துறைகளும் கால ஓட்டத்துடன் இணைந்து டிஜிட்டல் தளத்தில் பல்கிப்பெருகி வருகின்றன. அந்த வகையில் கல்வித்துறையும் இதற்கு விதிவிலக்கல்ல. இணையவழி கல்வியின் மூலம் கல்வித்துறை புதியதொரு பரிமாணத்தை எட்டியுள்ளது. குறிப்பாக கொரோனா பேரிடர் காலத்தில் நாடே முடக்கப்பட்டிருந்தது. இதனால் மாணவர்களிற்கும் பாடசாலை, கல்வி நிறுவனங்களிற்கு இடையிலான தொடர்பு துண்டிக்கப்பட்டது. அந்த இக்கட்டான சூழ்நிலையில் இணையவழி வகுப்புகள் மாணவர்களிற்கு வரப்பிரசாதமாக அமைந்தது என்பதே உண்மை.

இன்று தொழில்நுட்பம் மாணவர்களை தவறான பாதைக்கு இட்டு செல்வதாக ஓர் எண்ண ஓட்டம் மக்கள் மத்தியில் உள்ளது. தொழில்நுட்பம் என்பது ஒரு கருவி மட்டுமே அதை எவ்வாறு பயன்படுத்துகிறோம் என்பதில் அதன் ஆக்க மற்றும் அழிவு விளைவுகள் தீர்மானிக்கப்படுகிறது. உளியை கொண்டு சிலையை செதுக்க நினைத்தால் அவன் நிச்சயம் சிற்பி ஆகலாம். இங்கு பிரச்சினையாக காணப்படுவது மாணவர்களை வழிப்படுத்த தொழில்நுட்ப உலகில் ஓர் முறையான கட்டமைப்பு இல்லாமையே. அதை உருவாக்குவதே எங்கள் நோக்கம். அதை நோக்கியே எங்கள் பயணம் அமையும்.

எமது இணையத்தினூடக ஊடக உங்களிற்கு தேவையான பரீட்சை வினாத்தாள்களை இலகுவான முறையில் தரவிறக்கம் செய்து கொள்ளமுடியும்.

kalvi.lk

கல்வி சார் செய்திகளை உடனுக்குடன் அறிந்து கொள்ள எமது சமூக ஊடக தளங்களின் ஊடக உடனுக்குடன் அறிந்து கொள்ள முடியும்.



Viber
Community



Whatsapp
Channel



Facebook
Page